

COUNTY DITCH NO. 25

REDETERMINATION OF BENEFITS & DAMAGES

RICE COUNTY, MINNESOTA

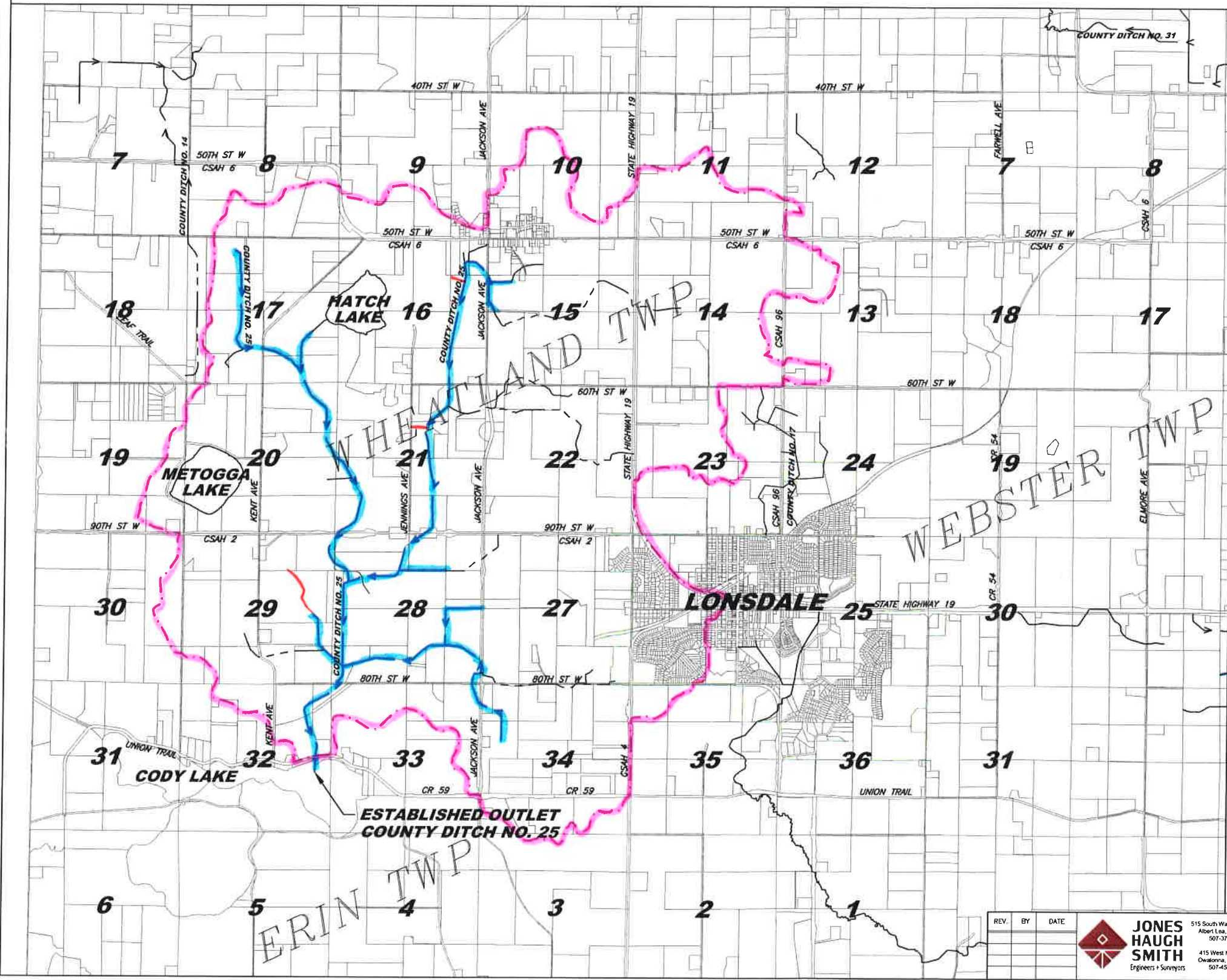

INDEX TO SHEETS

SHEET	SUBJECT
1	TITLE SHEET
2-7	WATERSHED MAP

LEGEND

- APPROXIMATE EXTERIOR WATERSHED
- APPROXIMATE INTERIOR WATERSHED
- APPROXIMATE ORIGINAL WATERSHED
- OPEN DITCH (Project)
- LEGAL OPEN DITCH (Not Project)
- PRIVATE OPEN DITCH
- TILE DITCH (Project)
- LEGAL TILE DITCH (Not Project)
- PRIVATE TILE
- WATERWAY
- NATURAL STREAM
- GAS LINE
- OVERHEAD ELECTRIC
- UNDERGROUND TELEPHONE
- CITY LIMITS
- FENCE LINE
- TILE INLET
- OVERHEAD TELEPHONE
- FIBER-OPTICS
- UNDERGROUND ELECTRIC
- LIGHT POLE
- POWER POLE

ABBREVIATIONS

- JD = JUDICIAL DITCH
- CD = COUNTY DITCH
- JCD = JOINT COUNTY DITCH
- MOD = MAIN OPEN DITCH
- LAT = LATERAL
- BR = BRANCH
- PVT = PRIVATE
- POD = PRIVATE OPEN DITCH
- LW = LOWWATER
- XG = CROSSING
- OL = OUTLET

No responsibility is accepted for the locations of utilities shown hereon. Verification of actual locations should be requested prior to the commencement of construction or the taking of any other action relying on the actual locations.

Locations of all utilities shown are approximate.
GOPHER STATE ONE-CALL: 1-800-252-1166

The subsurface utility information in this plan is Utility Quality Level D. This Utility Quality Level was determined according to the guidelines of C/ASCE 38-02, entitled "Standard Guidelines for the collection and depiction of existing subsurface utility data."

COPYRIGHT
by JONES, HAUGH & SMITH INC.
This drawing and format are protected by Copyright and all rights are reserved. The use of this drawing and format is strictly prohibited without the written consent and permission of Jones, Haugh & Smith Inc.

I hereby certify that this plan, specification, or report was prepared by me or under my direct supervision and that I am a duly Licensed Professional Engineer under the laws of the State of Minnesota.

Steven J. Penkava
Lic. No. 43895 Date: _____

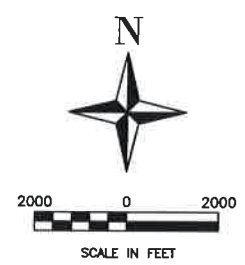

EXHIBIT A - DRAFT PLANS

RICE COUNTY, MN
COUNTY DITCH NO. 25
REDETERMINATION OF BENEFITS & DAMAGES
TITLE SHEET

SHEET
1
OF
7

REV.	BY	DATE	 JONES HAUGH SMITH Engineers + Surveyors	DESIGNED: SJP	515 South Washington Ave. Albert Lea, MN 56007 507-373-4876
				DRAWN: SJP	
				CHECKED: SJP	415 West North Street Owatonna, MN 55060 507-451-4598
				DATE: JAN 2017	
				FILE NO: 16-308.DWG	